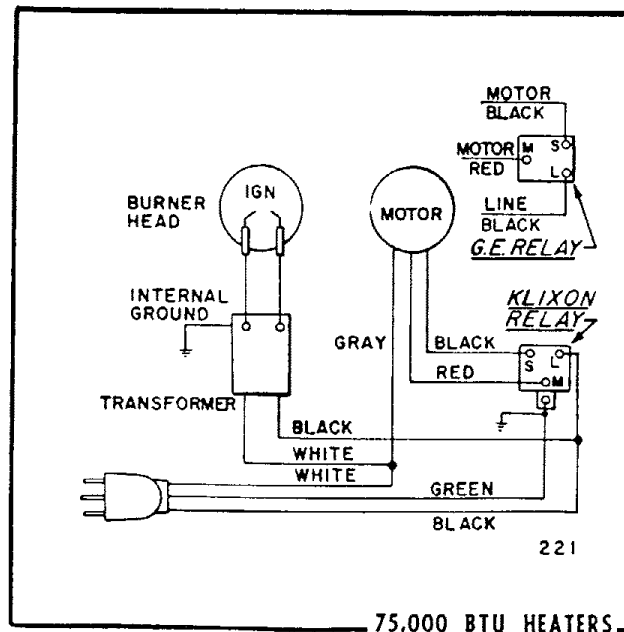

Figure 10.
 Model MB99E Portable
 Heater, Exploded View

Figure 6. Wiring Diagram



MODEL MB99E

Index No.	Part Number	Part Name	Quan. Per Spec. No.	
			2811G14-1	2811G14
1	M13134G1	Shell, Upper	1	-
1	M13134G3	Shell, Upper	-	1
(A)	*M11937G2	<u>Motor Package Assy</u>	1	1
2	M11938-2	Motor	1	1
(B)	*M13614G1	<u>Pump and Filter</u>		
		<u>Parts Package</u>	1	1
3	M11966-5	. Spring	1	1
4	M8643	. Blade	4	4
5	M11959	. Rotor	1	1
6	M8645	. Pump Body	1	1
7	FHPF3-4C	. Screw, Fil hd, 10-32 x 1-1/8 in.	2	2
8	M12233	. End Cover, Pump	1	1
9	WLI-3C	. Washer	6	6
10	*M11637	. Filter, Lint	1	1
11	M12461-32	. Screw, Hex hd, 10-32 x 1-1/8 in.	6	6
12	*M12244G1	. Filter Assy	1	1
13	*M12179	. Intake Filter	1	1
14	M12234	. End Cover	1	1
15	M10837	. Pipe Plug	1	1
(C)	M8943G2	<u>Pressure Relief</u>		
		<u>Valve Assy</u>	1	1
16	M10362	. . Connector	1	1
17	M8940	. . Ball, 1/4 dia.	1	1
18	M8941	. . Spring, Compression	1	1
19	M8993	. . Hex Nut, 3/8-24	1	1
20	M11941	. . Bushing, Pressure adjustment	1	1
21	69248	. Male Elbow	1	1
22	WLI-3C	. Lockwasher, Internal #10	4	4
23	M12461-31	. Screw, Hex hd, 10-32 x 1 in.	4	4
24	M11920G2	Combustion Chamber	1	1
(D)	*M11929G1	<u>Burner Assy</u>	1	1
25	M11931	. Elbow, Male, 45°	1	1
26	M5976	. Connector, Male	1	1
27	HF3-3C	. Screw, Hex hd, 10-32 x 3/8 in.	3	3
28	*M8989	. Electrode, LH	1	1
29	*M8990	. Electrode, RH	1	1
30	M8882	. Sleeve	1	1
31	M8667	. Nozzle	1	1
32	M10659-1	. Washer, Nozzle Seal	2	2
33	M10809-1	. Spring, Nozzle Seal	1	1
34	WP-3C	. Washer, Flat	1	1
35	M8716G2	. Burner Head	1	1
35A	M15995	Plug Button	1	1
36	M13846G1	Fuel Filter Assy	1	1
36A	1000577	Grommet (Air line and Fuel Filter)	-	2
37	No Number	Setscrew, Socket hd, cup pt, 1/4-28	2	2
38	M12464	Fan, 20° Pitch	1	1
39	M12331	Housing, Fan	1	-
39A	M15807	Strap, Retainer	-	1
40	NPC-4C	Nut, Hex, 1/4-20	2	2
41	WLM-4	Washer, Lock, 1/4	2	2
42	M13620	Spacer	2	2
43	M10964-1	Clamp, Motor	4	4
44	M12330	Bracket, Shell Support	1	1
44A	M15809	Plug	1	1
45	M11271-6	Nut, Tinnerman	1	1
45A	ST2-2AC	Screw, Rd hd, No. 8 x 1/4	1	1
46	M11942	Bracket, Motor Support	1	1

Index No.	Part Number	Part Name	Quan. Per Spec. No.	
			2811G14-1	2811G14
47	RC2-3C	Screw, Rd hd, 8-32 x 3/8 in.	2	2
48	WLI-2C	Washer, Lock, #8	2	2
49	M11952	Bracket, Relay Mounting	1	1
50	M12462-3	Relay	1	1
51	M9946G4	Wire Assy	1	1
52	M13942-4	Connector	1	1
53	M11084-27	Screw, 10-12 x 1/2, Type A	4	4
54	M12328-2	Shell, Lower	1	-
54	M15805	Shell, Lower	-	1
55	M11084-27	Screw, 10-12 x 1/2, Type A	9	9
56	HC4-10C	Screw, 1/4-20 x 1-1/4	2	2
57	M11084-27	Screw, 10-12 x 1/2, Type A	2	2
58	M11084-29	Screw, 10-12 x 3/4, Type A	4	4
59	M11954	Bushing, Strain Relief	2	2
60	M13942-4	Connector	1	1
61	M15779G2	Service Cord (Ext. Cord Assy)	1	1
62	M10990-3	Bushing	1	1
63	M12321G1	Fuel Tank Assy	1	1
65	M13990	Plug	1	1
66	M11084-27	Screw, 10-12 x 1/2, Type A	8	8
67	M3353	Cap, Fuel Tank	1	1
68	M10816G11	Lead Assembly, Electrode	2	2
72	*M12509G2	Transformer Assy, 220 V, 50 C	1	-
72	*M15804	Transformer, 220 V, 50 C	-	1
74	WP-4C	Washer, 1/4 in.	2	2
75	NTC-4C	Nut, Hex, 1/4-20, Torque-Lock	2	2
75A	M12332G1	Mounting Bracket	1	-
75B	M10908-51	Screw, No. 10-24 x 1/2, Type "S"	2	-
75C	M13042	Spacer	2	-
76	M11271-6	Nut, Tinnerman	6	6
77	M11084-27	Screw, 10-12 x 1/2, Type A	2	2
77A	*M11943	Air Line	1	1
78	M13830	Handle, Rear	1	1
79	M12345-34	Screw, 10-24 x 1-3/4, Oval hd	8	8
80	M12342	Frame, Wheel Support	1	1
81	NTC-3C	Nut, 10-24	8	8
82	M11957	Axle	1	1
83	M14830	Wheel	2	2
84	WP-8C	Washer	2	2
85	C4-7	Cotter Pin	2	2
86	M12336	Sleeve, Alignment	2	2
87	M13831	Handle, Front	1	1
88	M13502	Hub Cap	2	2

* Parts recommended for normal service replacement.

MOBIL-MATIC PORTABLE HEATER MODEL MB120E Spec. Nos. 2827G17 & 2827G17-1
 Form No. 2058 (9/66)

MODEL MB120E

Index No.	Part Number	Part Name	Quan Per Spec. No.		Index No.	Part Number	Part Name	Quan Per Spec. No.	
			2827G17	2827G17-1				2827G17	2827G17-1
1	M13520G3	Shell, Upper	-	1	52A	M15809	Plug	1	1
1	M13520G1	Shell, Upper	1	-	53	M11271-6	Nut, Tinnerman	6	6
(A)	*M12864G2	Motor Package Assy	1	1	54	M11084-27	Screw, 10-12 x 1/2 in., Type A	6	6
2	M12811-2	Motor	1	1	55	M11084-27	Screw, 10-12 x 1/2 in., Type A	8	8
3	M8947	End Shield, front	1	1	56	M11084-29	Screw, 10-12 x 3/4 in., Type A	4	4
(B)	M15442G1	Pump and Filter Parts Package	1	1	57	M5890	Grommet	1	-
4	M11966-5	Spring	1	1	57A	M6756	Plug Button	-	1
5	M8643-3	Blade	4	4	58	M13942-4	Connector	2	2
6	M11969	Rotor	1	1		M9900G54	Wire Assembly	1	-
7	M8645-3	Pump Body	1	1		M9900G51	Wire Assembly	-	1
8	FHPF3-7C	Screw, Fil hd, 10-32 x 1/2 in.	2	2	59	M15779G2	Extension Cord Assy	1	-
9	M12233	End Cover, Pump	1	1	59	M15779G7	Extension Cord Assy	-	1
10	WLI-3	Washer	6	6		M15823-26	Screw, No. 10-12 x 3/8, Type "B" (Grounding)	-	1
11	*M11637	Filter, Lint	1	1	61	M12826	Shell, Lower	1	-
12	M12461-34	Screw, Hex hd, 10-32 x 1-1/2 in.	6	6	61	M15810	Shell, Lower	-	1
13	*M12244G1	Filter Assy	1	1	62	NTC-4C	Nut, Hex, 1/4-20, Torque-Lock	2	2
14	*M12179	Intake Filter	1	1	63	WP-4C	Washer, 1/4 in., Flat	2	2
15	M12234	End Cover	1	1	64	M11084-27	Screw, 10-12 x 1/2, Type A	4	-
16	M10837	Pipe Plug	1	1	65	M12841G1	Mounting Bracket	1	-
(C)	M8943G2	Pressure Relief Valve Assy	1	1	66	M6087	Grommet	1	-
17	M10362	Connector	1	1	67	*M8434-3	Transformer, 220 V, 50 C	1	-
18	M8940	Ball, 1/4 dia.	1	1	67A	M15804	Transformer, 220V, 50 C	-	1
19	M8941	Spring, Compression	1	1		STP2-2A	Screw, No. 8 x 1/4, (Grounding)	1	-
20	M8993	Hex nut, 3/8-24	1	1	68	M14985G1	Cover, Transformer	1	-
21	M11941	Bushing, Pressure adjustment	1	1	69	M14986	Plate, Cover	1	-
22	M12865	Male Elbow	1	1	70	FHPF3-3C	Screw, Fil hd, 10-24 x 3/8 in.	4	-
23	WLI-3	Lockwasher, Internal #10	4	4	71	M11143-1	Bushing, Strain Relief	1	-
24	M12461-31	Screw, Hex hd, 10-32 x 1 in.	4	4	71	M11954	Bushing, Strain Relief	-	2
25	M12934G1	Combustion Chamber	1	1	72	M10816G20	Lead, Electrode	2	2
25A	M15995	Plug Button	1	1	73	M3353	Cap, Fuel Tank	1	1
(D)	*M12947G3	Burner Assy	1	1	74	M14260	Bushing, Rubber	1	1
26	M14256	Elbow	1	1	75	M12820G4	Fuel Tank	1	1
27	M12949	Connector	1	1	76	M13990	Plug	1	1
28	HF3-3C	Screw, 10-32 x 3/8 in.	3	3	77	M11084-27	Screw, 10-12 x 1/2 in., Type A	8	8
29	M12952	Electrode, RH	1	1	78	M14243	Handle, Rear	1	1
30	M12951	Electrode, LH	1	1	79	M12345-33	Screw, Mach, oval hd, 10-24 x 1-3/4 in.	8	8
31	WP-3C	Washer, Flat	1	1	80	M12831	Frame, Support, wheel	1	1
32	M14293	Nozzle, Siphon	1	1	81	NTC-3C	Nut, 10-24	8	8
33	M10659-1	Washer, Nozzle Seal	2	2	82	M12867	Axle	1	1
34	M10809-1	Spring, Nozzle Seal	1	1	83	M14830	Wheel	2	2
35	M8882	Sleeve	1	1	84	WP-8C	Washer	2	2
36	M12948G1	Burner Head	1	1	85	C4-7	Cotter Pin	2	2
37	M14259G1	Fuel Filter	1	1	86	M12336	Sleeve, Alignment	2	2
38	No Number	Setscrew, Socket hd, cup pt, 1/4-28	2	2	87	M14244	Handle, Front	1	1
39	*M13784	Fan, 14° pitch	1	1	88	M13502	Hub Cap	2	2
40	M12830	Fan Housing	1	1					
41	NPC-4C	Nut	2	2					
42	WLM-4	Lockwasher, 1/4 in.	2	2					
43	M10964-1	Clamp, Motor	4	4					
44	M13620	Spacer	2	2					
45	HC4-10C	Screw, 1/4-20 x 1-1/4	2	2					
46	M14245	Air Line	1	-					
46	M15970	Air Line	-	1					
46A	1000577	Grommet	-	1					
47	M12828	Bracket, Shell Support	1	1					
48	1000577	Grommet	2	2					
49	M12829	Bracket, Motor Support	1	1					
50	M10908-58	Screw, 10-24 x 1-1/2, Type S	1	1					
51	M12651	Clamp, Tinnerman	1	1					
52	M12650-3	Capacitor	1	1					

* Parts recommended for normal service replacement.
 ** When installing replacement for M8434-3 transformer, shorten leads as needed to fit within housing.

MODEL MB120E

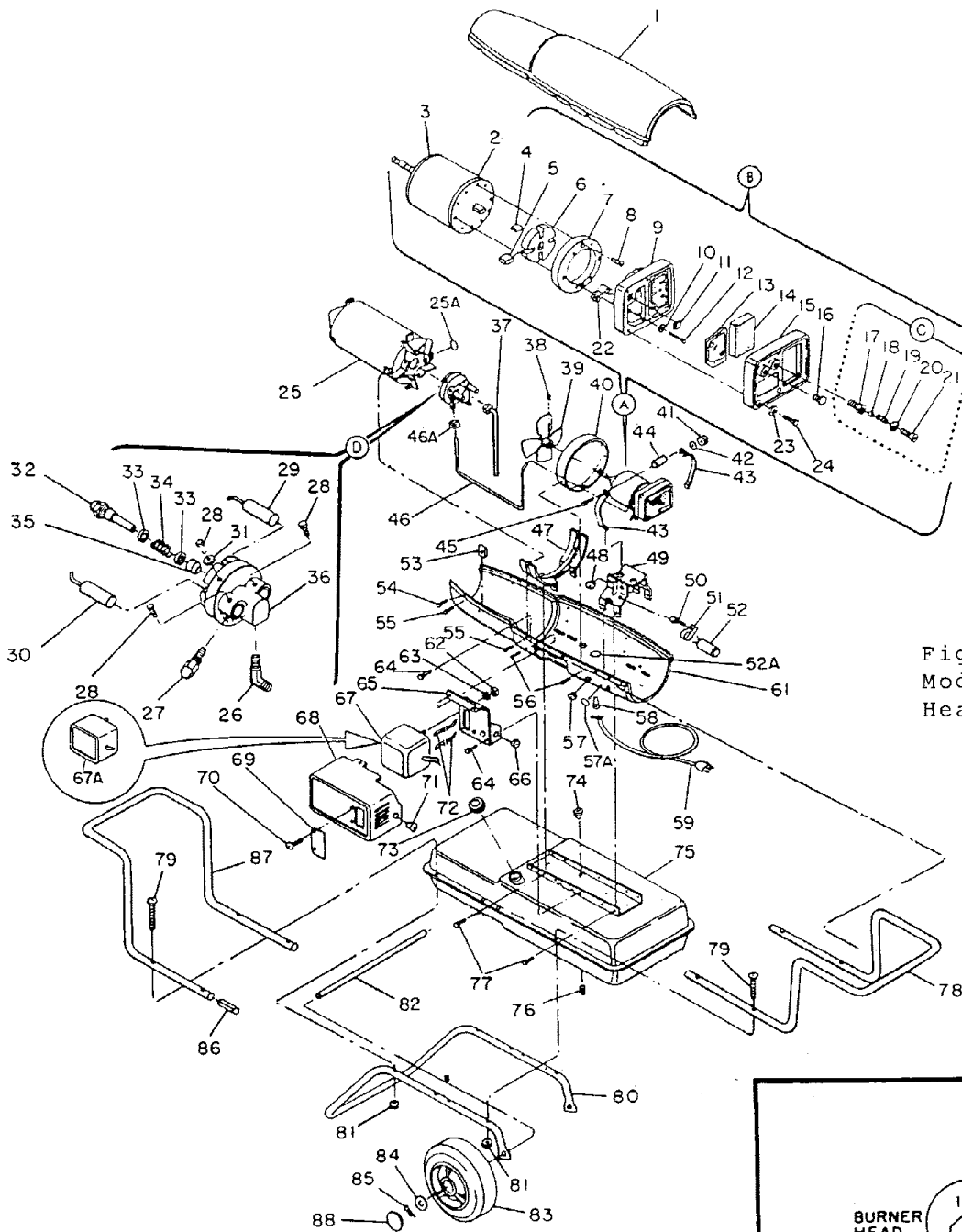

Figure 11.
Model MB120E Portable
Heater, Exploded View

Figure 6. Wiring Diagram

